

## Up on the Cloud

---

[Use Neuron with mBlock](#)

---

[Getting Started](#)

---

[Electronics Guide](#)

---

[Using the Wifi Block](#)

---

[Up on the Cloud](#)

---

[Setup Microsoft Cognitive Service](#)

## Up on the Cloud

In the “Control” tab of the Node Shelf, you can create nodes such as Buttons or Switches. These Buttons and Switches are unlike physical Neuron Blocks. You can interact with them on the iPad Screen.

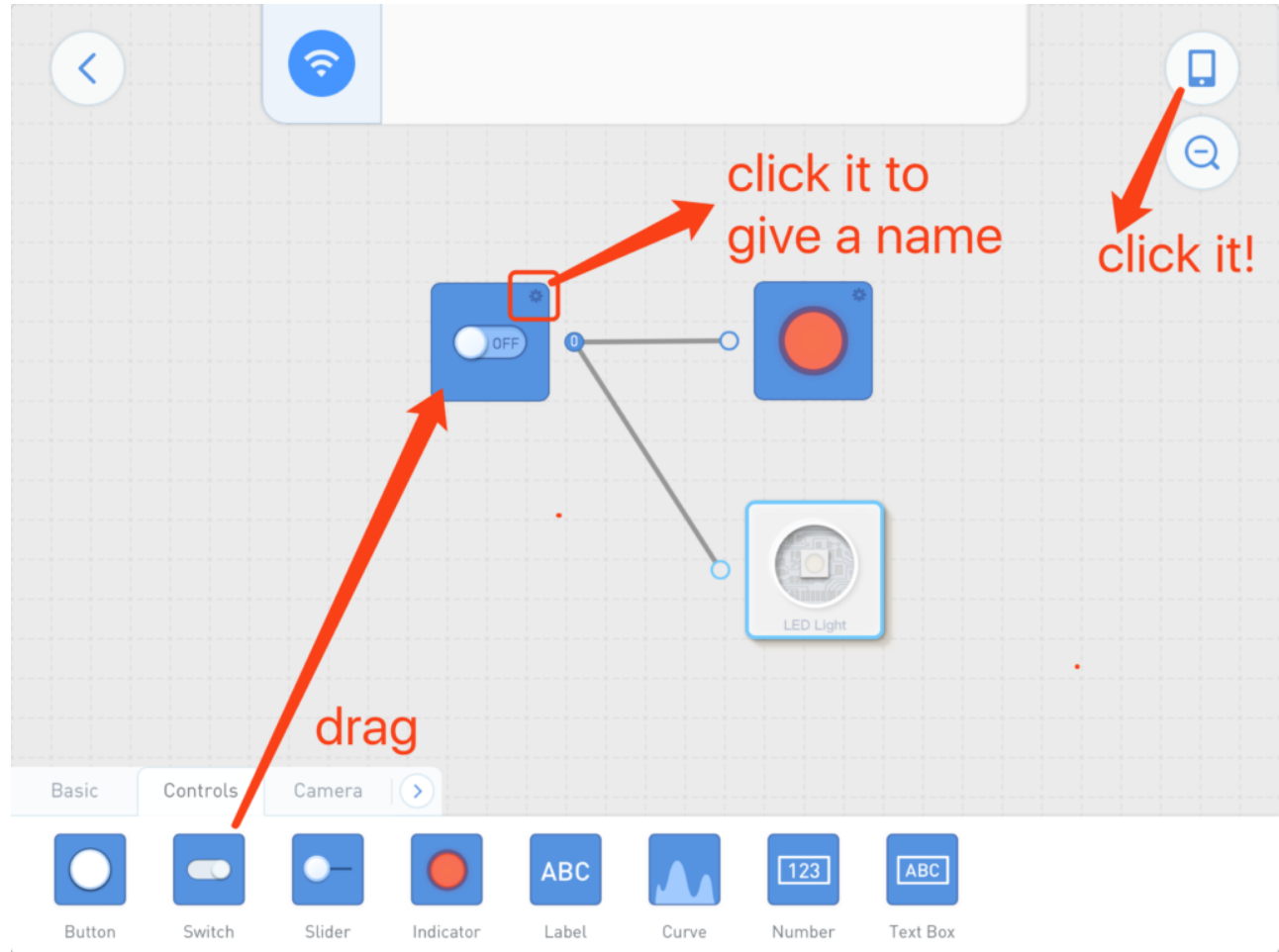

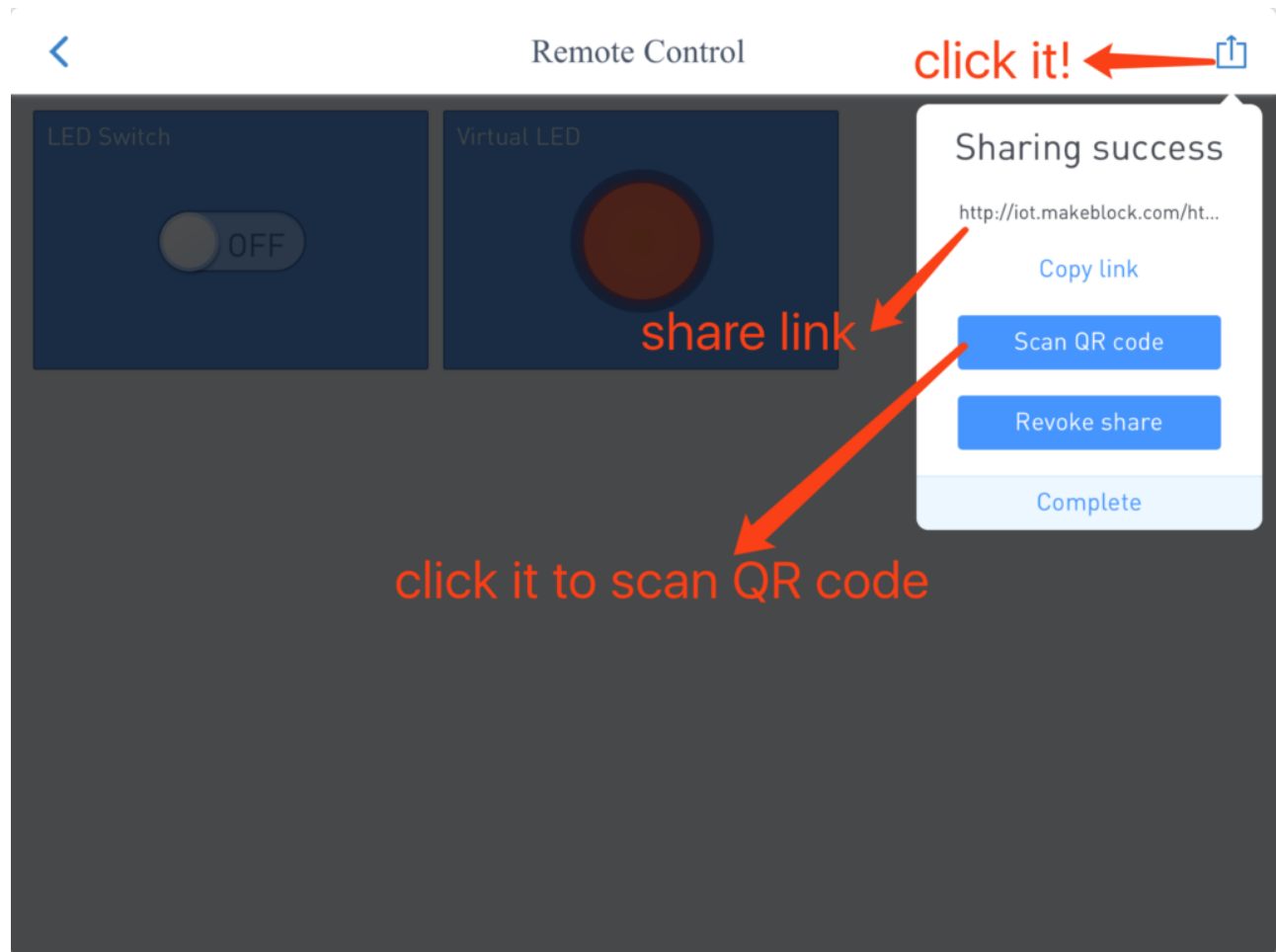

These nodes under “Control” tab has a second function. They form a control panel you can access through the button at the right top of the screen. At the control panel, it is possible to create a link and QR code using the “Share” button. Then you may open the link in your cell phone, to control your project from remote places.



# Remote Control



LED Switch



Virtual LED



Please scan QR code



OK

## COMPANY

---

[Home](#)

[Learn](#)

[Community](#)

[Blog](#)

[mBlock](#)

## SUPPORT

---

[About Us](#)

[Contact Us](#)

[Distributors](#)

[Become a Distributor](#)

[Help](#)

[Show Case](#)

[Site Map](#)

## CONTACT

---

Email:

ntec-support@makeblock.com

Address:

3rd Floor, Building C3, Nanshan iPark,  
No.1001 Xueyuan Avenue, Nanshan District,  
Shenzhen, Guangdong Province, China

Post Code: 518055

## DOWNLOAD

---



© 2013-2017 Makeblock Co., Ltd. All rights reserved.